



# Modular Genius

SMART BUILDING

## GENERAL BUILDING INFORMATION:

DRAWING NUMBER: M-1  
DRAWING: PLENUM WALL DETAIL

www.modulargenius.com  
(888)420-1113

## GENERAL CODE INFORMATION:

- THE MINIMUM AND MAXIMUM NUMBER OF WINDOWS AND DOORS SHALL BE LIMITED. CONSIDERATION MAY BE TAKEN TO THE CODE REQUIREMENTS FOR EGRESS AND ENERGY CONSERVATION.
- REQUIRED PLUMBING FIXTURES ARE SUBJECT TO THE ADOPTED PLUMBING CODE. CONSIDERATION MAY BE TAKEN FOR EXISTING RESTROOMS ON SITE.
- THE BUILDING SQUARE FOOTAGE SHALL BE LIMITED TO THE REQUIREMENTS OF THE ADOPTED BUILDING CODE.
- THE BUILDING SHALL BE SET WITH A PERMANENT OR TEMPORARY FOUNDATION SYSTEM AND APPROVED BY THE LOCAL OFFICIAL HAVING JURISDICTION.
- THE FINAL LAYOUT IS SUBJECT TO REVIEW FOR COMPLIANCE WITH THE BUILDING CODE ENFORCED IN THE AREA THE BUILDING WILL BE LOCATED.

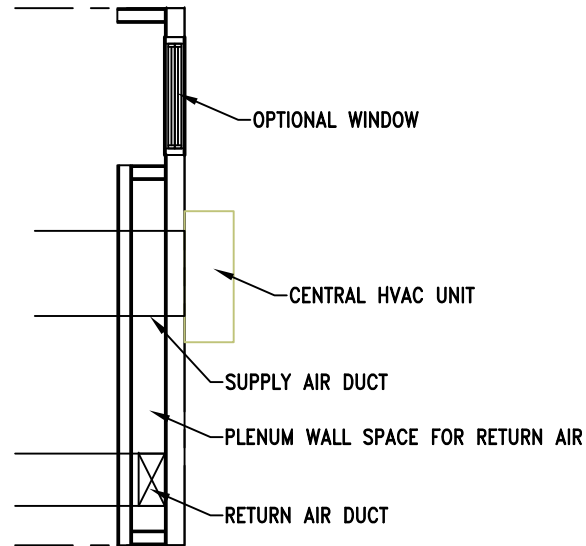

TYPICAL CENTRAL HVAC PLENUM WALL

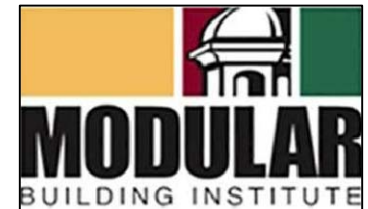

ASK ABOUT GREEN, SUSTAINABLE BUILDING OPTIONS